



Installation and user manual



ELECTRIC DESIGN FIREPLACES

DON'T COMPROMISE.



serial number:

Product group:	Electric design fireplaces
Model:	Kalfire E-one 100F
Version:	July 2020
Language:	English



Table of contents

1	Preface	4
1.1	Introduction	4
1.2	Receiving inspection	4
1.3	CE declaration	4
2	General safety regulations	4
2.1	Additional general safety regulations with option Atmos Heating	4
3	Existing electrical installation	5
4	Assembly of the fireplace	5
4.1	Removal of covers	5
4.2	Assembly rear screen	6
	option: Dual HD Flame technology	6
4.3	Assembly top screen	7
	option: Dual HD Flame technology	7
4.4	Assembly top display	7
	option: Single HD Flame technology	7
4.5	Placing design bottom plates	8
4.6	Placing lower sidewalls	8
4.7	Placing log set	9
4.8	Placing glass reflector	10
4.9	Placing upper side walls	10
4.10	Placing front window	10
4.11	Adjusting fireplace	11
4.12	Connecting fireplace to mains power	11
4.13	Bluetooth pairing E-one remote	11
5	Placing the fireplace	12
5.1	Ventilation openings	12
5.2	Fireplace finishing in combination with Atmos Heating	12
6	Operation E-one, design your own experience	12
6.1	E-one remote and symbols	12
6.2	Main switch	13
6.3	Hotel switch	13
7	Maintenance	14
8	Troubleshooting	14
8.1	Incorrect position of the flames	14
9	Technical data	15
10	Declaration of Conformity	15
11	Dimension drawing	15

1 Preface

Dear customer,

We are glad you chose Kalfire. We develop and produce fireplaces with the aim of connecting people, with themselves and each other. We hope this product will fulfil this function in your home.

We thank you for your trust in us and wish you many enjoyable evenings with friends and family.

Beijko van Melick

1.1 Introduction

Kalfire stands for innovation and quality. This is why Kalfire works continuously on the further development of its products. We reserve the right to make changes to the form, technology, and design of the products we sell. No claims can be made on the basis of information and figures from this booklet.

This manual is protected by copyright. All rights are reserved, particularly the right to copy, translate, and process.

The fireplace may only be installed by a qualified installer, in accordance with national or local regulations. Please read this installation manual carefully.

1.2 Receiving inspection

On receipt, check the following:

- 1) Verify that the packaging is not damaged
- 2) Check the glass panels and display screens of the product for cracks.
- 3) Check that you have received all of the following parts:
 - Fireplace: E-one 100F or E-one 100F *FR*
 - Decoration set
 - Top screen (Single HD Flame technology)
 - Glass reflector
 - Front window
 - E-one remote control
 - Installation and operating instructions
 - Rear screen (option: Dual HD Flame technology)
 - Design bottom plates (option)
 - Spacer plates (4x)

1.3 CE declaration

The E-one complies with the following CE standards:

- EN/IEC 62368-1:2014/A11:2017
- IEC/EN 60335-2-30:2009
- EN 62311:2008
- EN 55032 (2015) + AC (2016)
- Article 3.2 Radio testing Harmonized EN - compliant with the essential requirements of article 3.2 of the RED Directive

2 General safety regulations

When using electrical appliances, necessary precautions must always be taken to reduce and/or prevent the risk of fire, electric shock, and personal injury, including:

- Caution: to reduce the risk of electric shock, do not remove the ember bed.
- The unit contains no user-serviceable parts, except cleaning of the glass reflector and front window. Leave maintenance and repairs to a qualified service provider.
- If the unit is damaged, contact the supplier first.
- Do not use the fireplace outdoors.
- Do not use the fireplace in the immediate vicinity of a bath, shower, or swimming pool. The relative humidity must be <85%.
- Do not place the fireplace directly under a wall socket or junction box.
- If a malfunction occurs, set the main switch on the front panel to 0 (OFF).
- Do not place the unit on carpet or rugs.
- To prevent overheating of the fireplace, it must not be covered. Do not place any material in front of or against the unit and, in particular, do not obstruct the air circulation around the unit. When materials overheat, there is a risk of fire.
- The fireplace may be operated by children aged eight years and over, by people with reduced physical, sensory, or mental abilities provided they have demonstrated an understanding of the instructions relating to the safe use and the dangers of the fire. Children should not be allowed to play with the fire, or be involved in any tasks pertaining to the maintenance of the fire. Children are not allowed to play with the fireplace. Children must not clean the fireplace or perform user maintenance without parental supervision.
- Children under the age of 3 should not be allowed near the fire without adult supervision. Children from three to seven years old may only switch the fireplace on/off provided that it is placed or installed in its intended normal working position and that they have been given explanation and instructions on how to use it safely and understand the dangers. Children three to seven years old must not clean the fireplace or perform user maintenance.
- If the power lead becomes damaged, it must be replaced by the supplier or another qualified service provider to avoid danger.

2.1 Additional general safety regulations for Atmos Heating option

- The fireplace does not have an automatic temperature regulator. If the fireplace is installed in a small room, each person

present in the room must be able to leave the room independently. Any person who is not, must be continuously supervised.

- Some parts of the fire can become very hot and could potentially cause burns. Always maintain supervision of children and vulnerable people around the fire.
- Furniture, curtains, and other combustible materials must be placed at least one metre away from the fireplace.

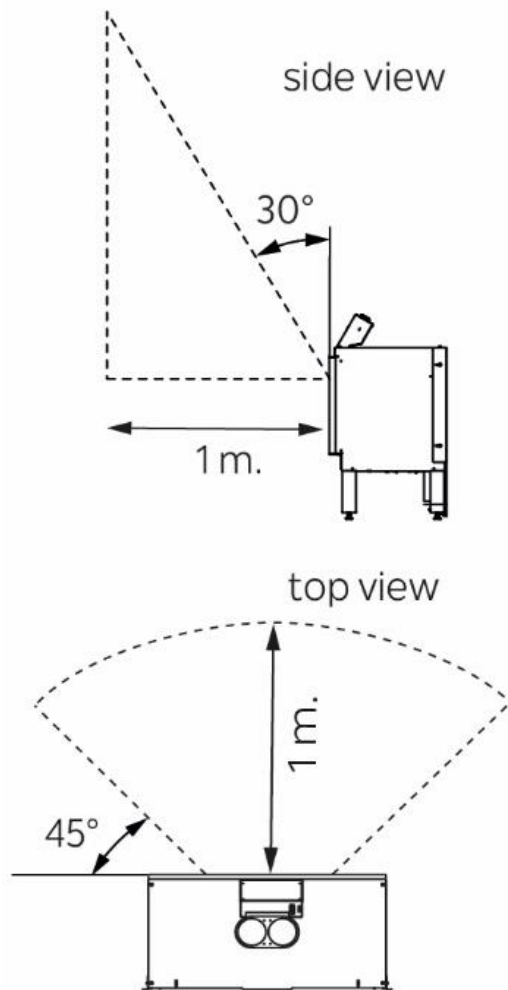

3 Existing electrical installation

The unit must be connected to a 230V AC/50Hz 13 A earthed mains socket.

4 Assembly of the fireplace

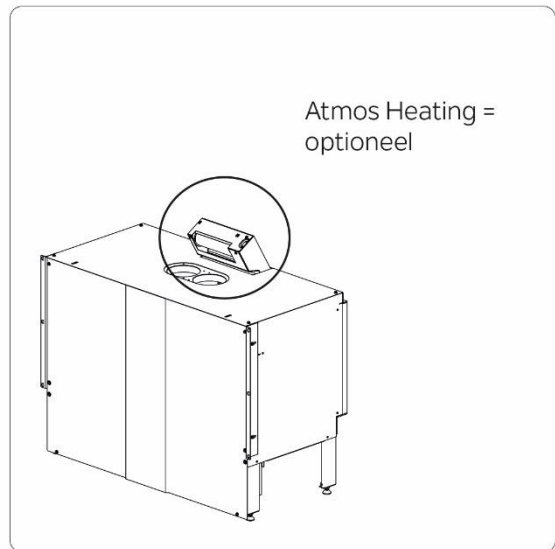
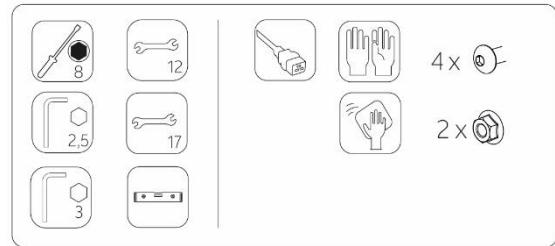

Do not use tie wraps to re-fasten cables during installation.

4.1 Removal of covers

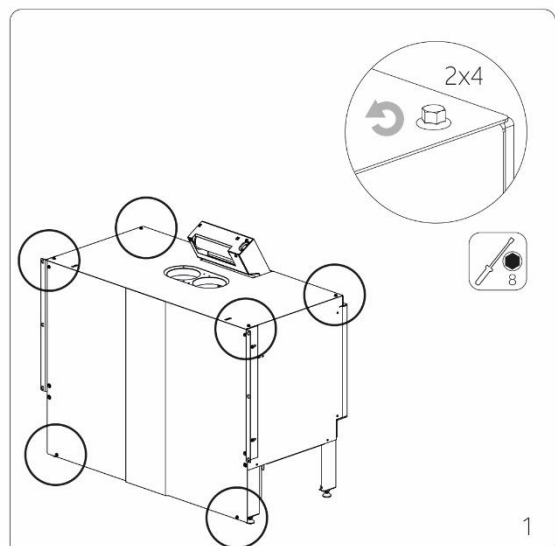

4.2 Assembly rear screen option: Dual HD Flame technology

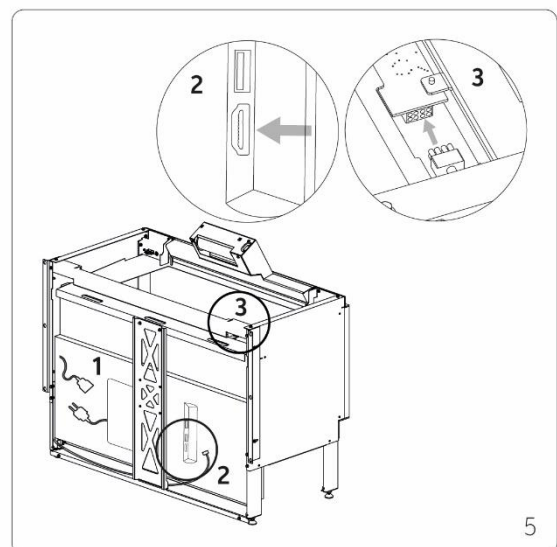
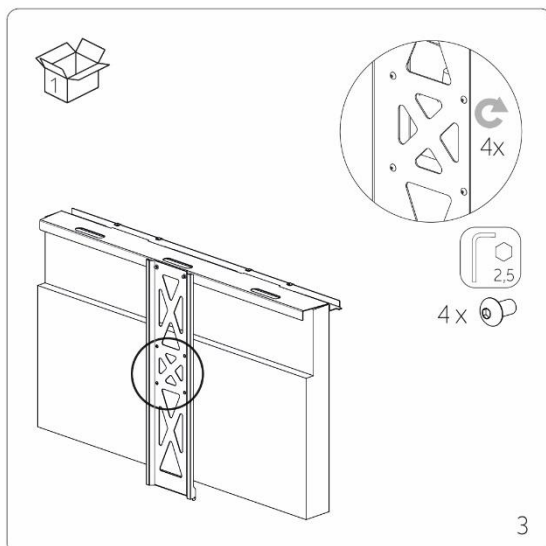
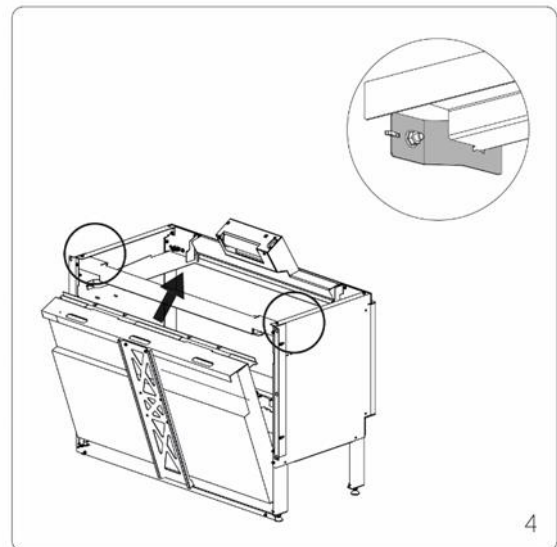
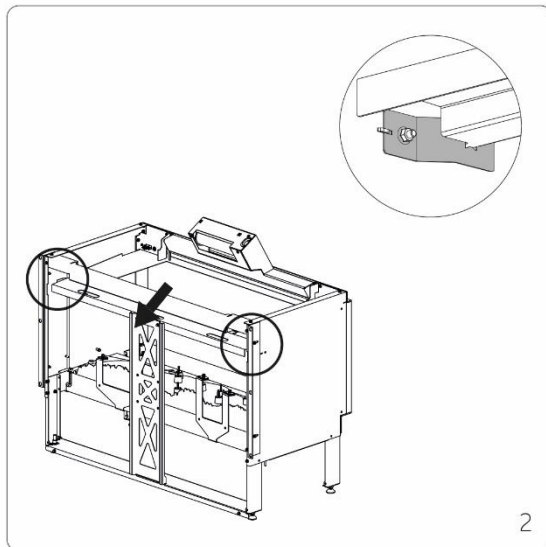

4.3 Assembly top screen option: Dual HD Flame technology



4.4 Assembly top display option: Single HD Flame technology

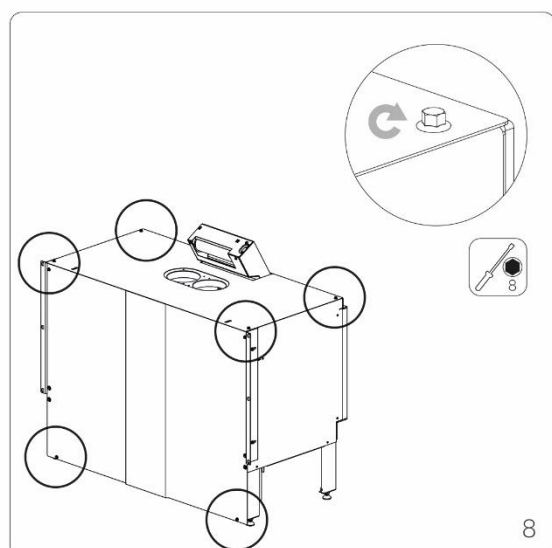
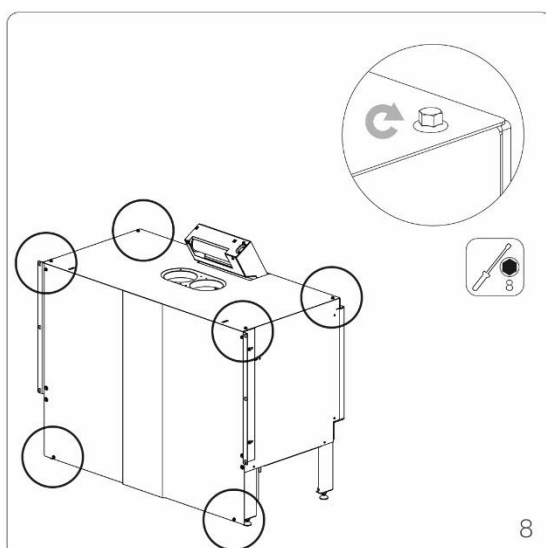
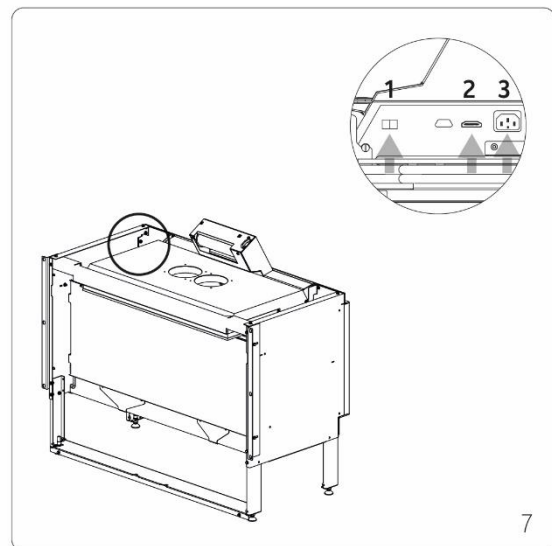
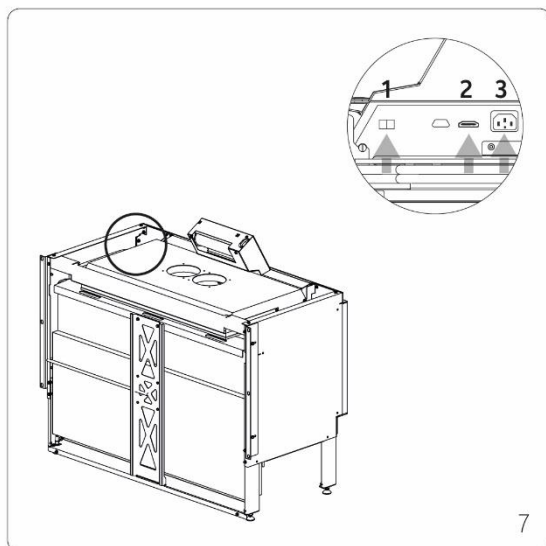
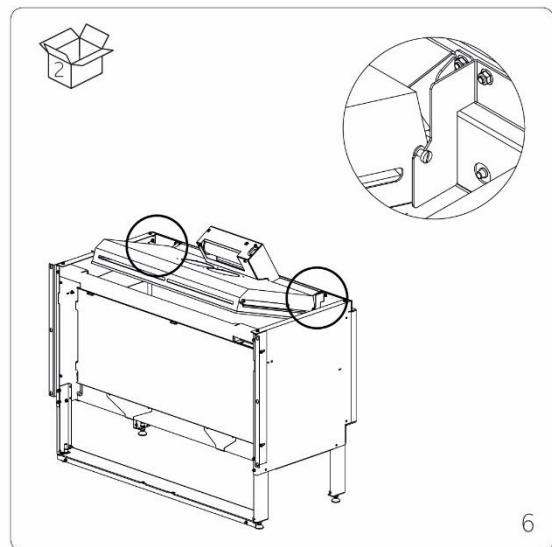

4.5 Placing design bottom plates

Please note: If a flat bottom plate was chosen, this step can be skipped. The flat base plate is pre-installed during production.



The design bottom plates are made of ceramic material. Pieces can break off on contact with hard materials. Therefore, proceed with extreme caution when installing the bottom plates.



9a

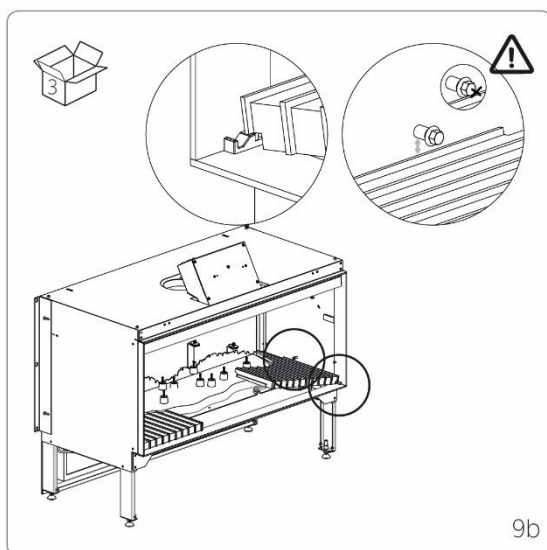

9b

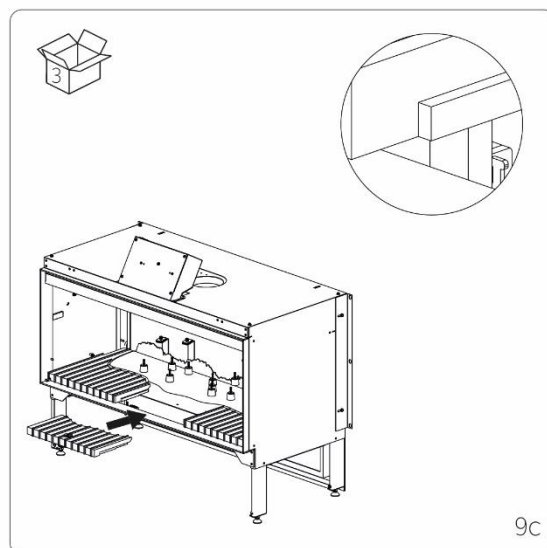

9c

4.6 Placing lower sidewalls

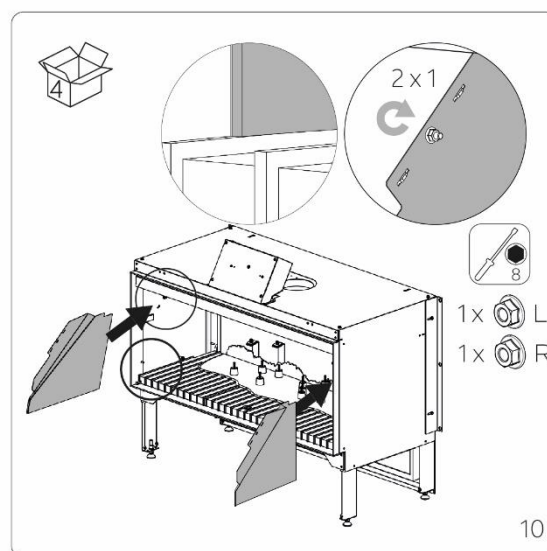

10



Make sure that the lower side walls are parallel to the rear wall.

4.7 Placing log set

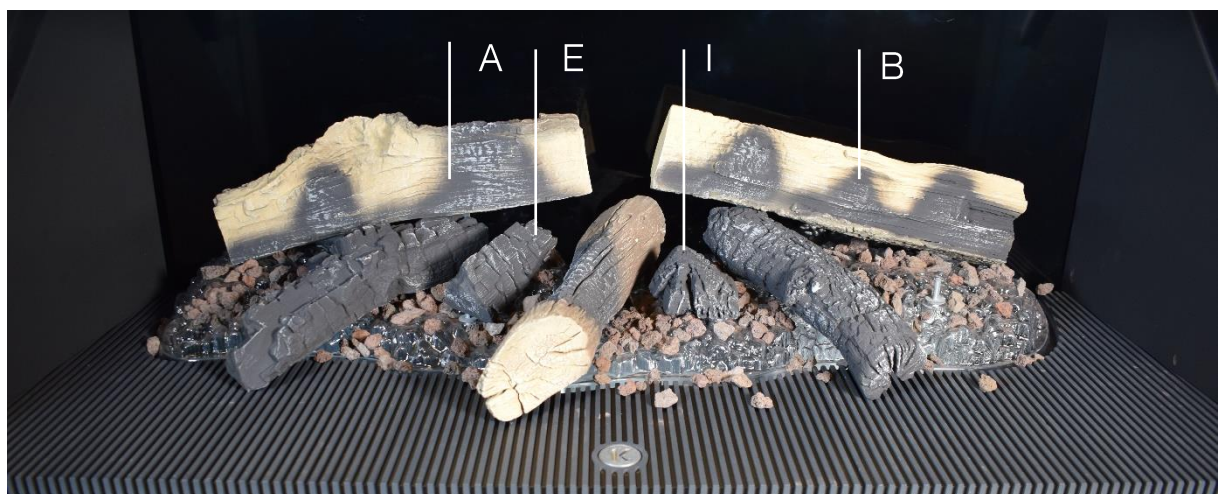
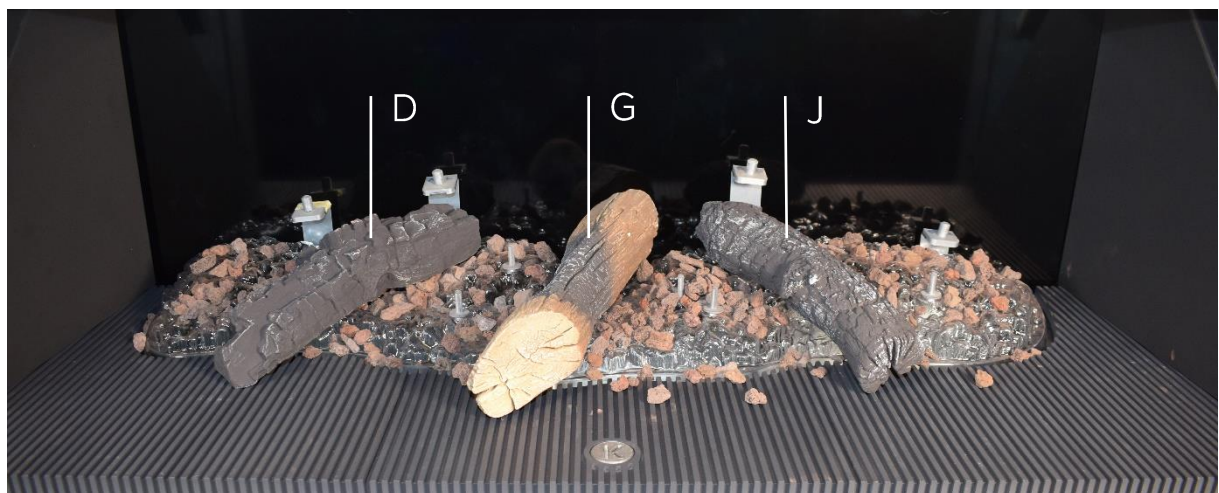

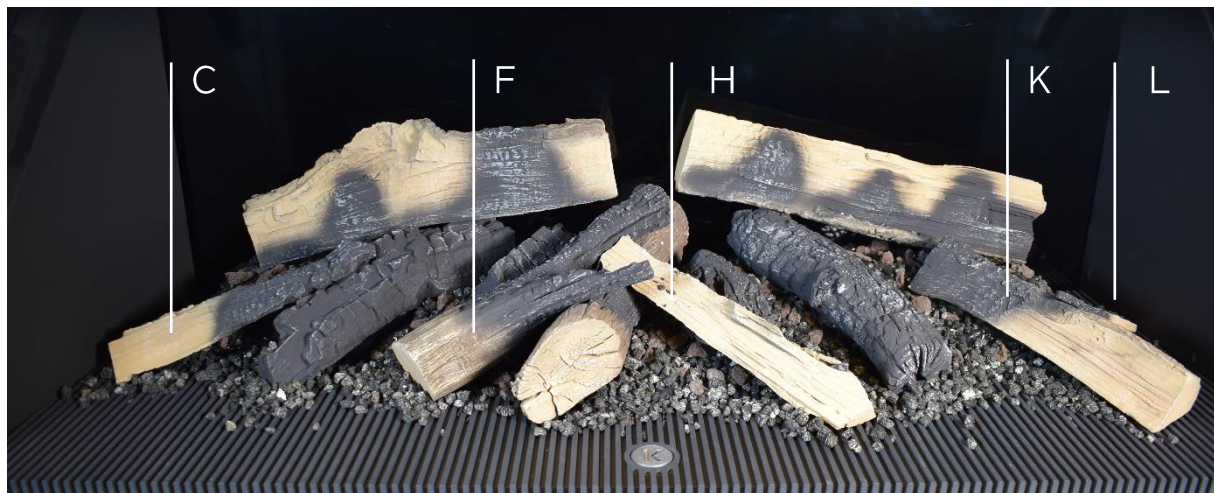

4.8 Placing glass reflector

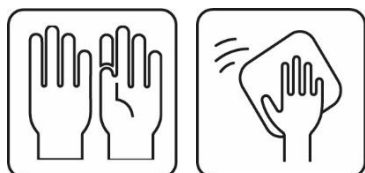

The glass reflector is susceptible to stains and fingerprints. For this reason, always use the supplied gloves for installation.

To clean the glass reflector, follow the cleaning instructions provided in chapter 7.

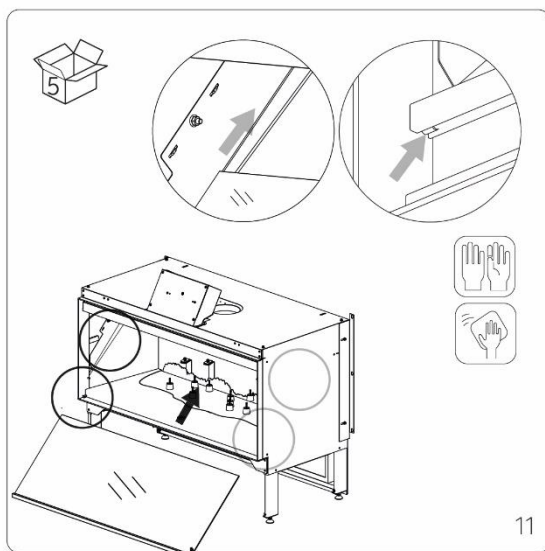

4.9 Placing upper side walls

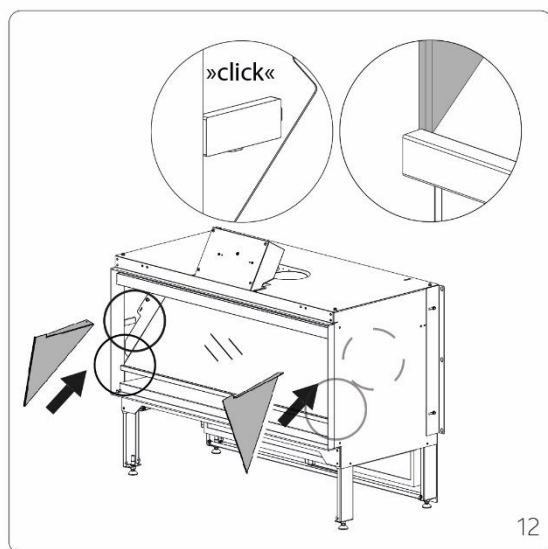

4.10 Placing front window

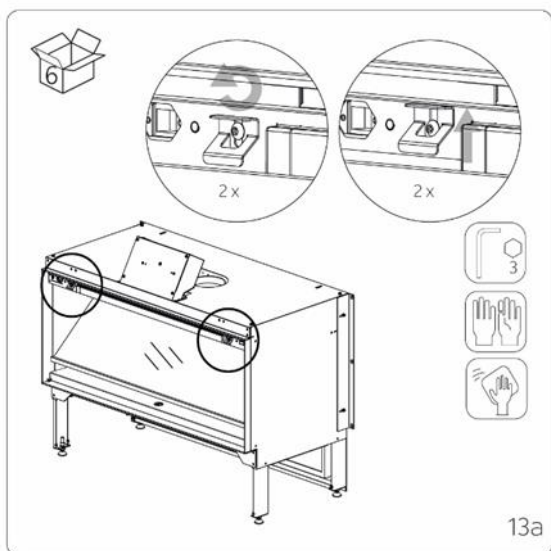



When levelling the fireplace, make sure the front window is parallel to the frame of the fireplace.

4.12 Connecting fireplace to mains power

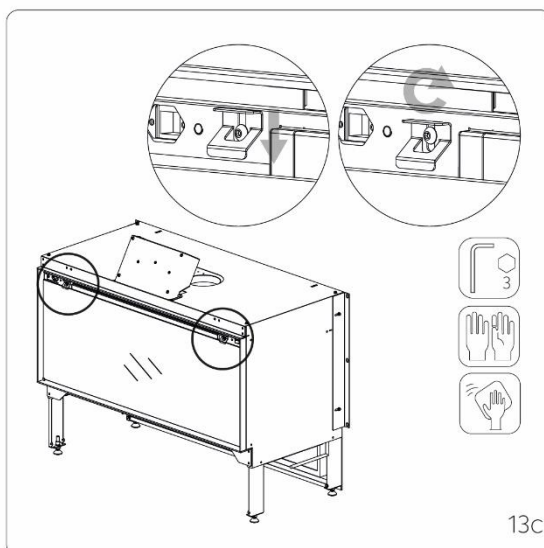
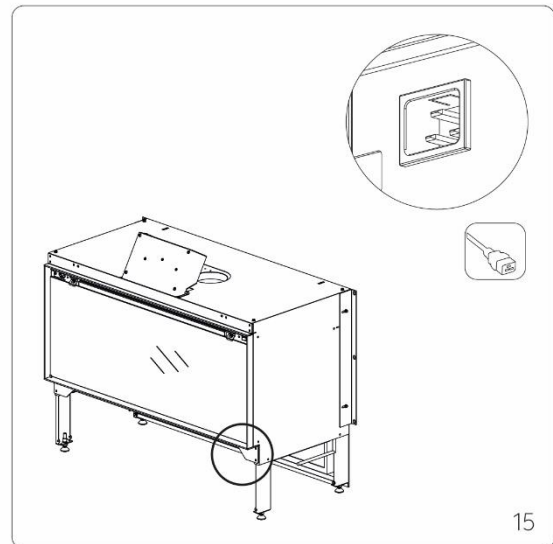

4.13 Bluetooth pairing E-one remote

When the fireplace is used for the first time, the remote control will connect to the fire automatically. If the following symbol is projected on the rear screen, the remote control must be paired manually:

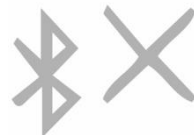

4.11 Adjusting fireplace

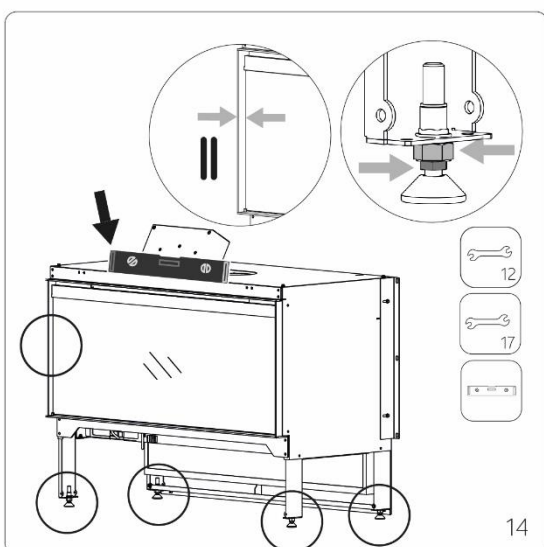

Pairing is done by pressing the two buttons as shown below..

Press the  and  buttons on the remote control at same time.

Release the buttons when a red LED light flashes in the top-left corner of the remote control. You will know when the remote control is paired with the E-one successfully once the Bluetooth symbol is no longer visible.

5 Placing the fireplace

Once you have levelled the fire, it is strongly recommended that you attach it to the wall using the wall brackets for added stability and safety.

5.1 Ventilation openings

The finishing of the fireplace must have sufficient ventilation. Ventilation must be provided at both the bottom and top of the housing. Each opening must be at least 100 cm².

5.2 Fireplace finishing in combination with Atmos Heating

Maintain a minimum clearance of 2 mm between the surround and the fireplace for heat transfer and expansion. Too little space will result in temperatures above 80 °C and unwanted material stresses.

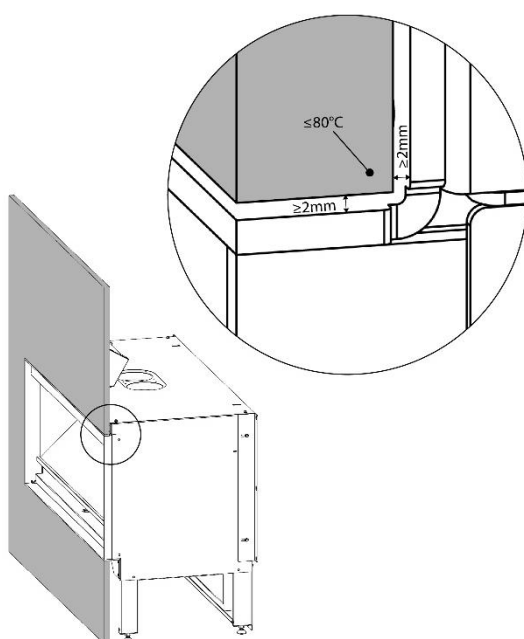

6 Operation E-one, design your own experience

With the E-one you can create your own fire experience through the various functions and/or options.

6.1 E-one remote and symbols



Atmos Heating (ON/OFF switch)

The specially developed Atmos Heating element provides a pleasant atmospheric warmth, contributing to the ultra-realistic fire experience. Available as an option for the Kalfire E-one 100F



Flame Tones

Create your own flame image by choosing between three flame tones created by Kalfire and adjust the flame intensity as desired.



Adjustable Flame Height

The flame height is adjustable from positions 1 to 5. The 6th position is the Flame Shuffle mode. In Flame Shuffle mode, dynamic flames are created at the touch of a button.



Atmos Lighting

Atmos Lighting projects true shadow effects on the wood-effect ceramic logs, enhancing the ultra-realistic fire experience. The intensity is adjustable from positions 1 to 5. The 6th position is the Atmos Lighting Shuffle mode. The AtmosLighting Shuffle mode creates a dynamic flicker effect within the interior.



Hybrid LED E

The Hybrid LED E ember bed simulates a real glowing bed of a fire. The intensity is adjustable from positions 1 to 5. The 6th position is the Hybrid LED E Shuffle mode which creates a dynamic glowing effect at the bottom of the logs.



Kalfire Sound

Choose between the full-bodied crackling sound of pine wood or the calmer and relaxing sound of beech wood. The sound of burning wood in combination with lifelike sparks enable a true sensory experience. The volume of Kalfire Sound can be adjusted between positions 0 and 5.



Anti-Reflect Function

This button has three functions, namely on, off, and the anti-reflect function.

There are two ways to switch off the fireplace:

Briefly press the  (on/off) button for the anti-reflect function. In this standby mode, the fireplace will be attractively lit. This provides a nice view of the logs, even when the fire is not burning.

Switching the fireplace off

Press the on/off button for two seconds and the fire will go out completely.

Switching the fireplace on

Briefly press the on/off button. It takes about 30 seconds for the fireplace to fully start up.

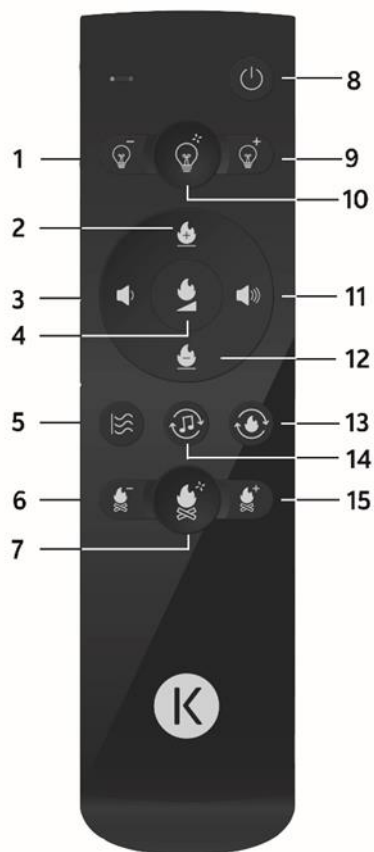

1. Atmos Lighting dimmer
2. Flames higher/flame shuffle
3. Kalfire sound softer
4. Flame intensity
5. Atmos Heating
6. Hybrid LED intensity lower
7. Dynamic Hybrid LED on/off
8. Power on/off / Anti-reflect function
9. Atmos Lighting brighter
10. Atmos Lighting on/off
11. Kalfire sound louder
12. Flames lower
13. Adjustable flame tones
14. Kalfire sound
15. Hybrid LED intensity higher

6.2 Main switch

Power to the fireplace can be switched off using the on/off switch (0/I) on the front. The button is located at the top right, behind the metal flap (see figure). You lift the metal flap a little towards you. If the unit is completely disconnected from mains power, the unit will be reset to the factory settings.

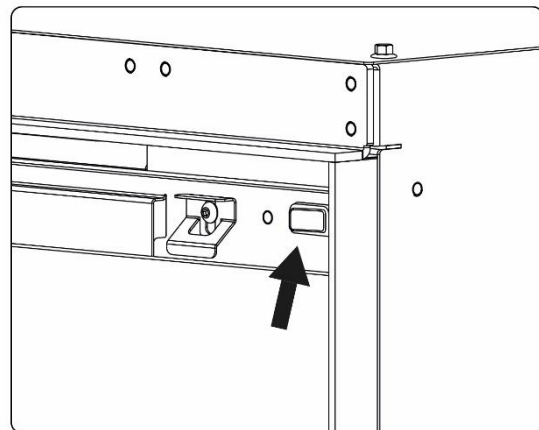

IMPORTANT: If you do not intend to use the unit for a long period of time, we advise you to switch off the unit completely by setting the power button on the unit itself to the 0 position.

6.3 Hotel switch

The fireplace can be turned off by means of an external switch. If the two terminal connections are short-circuited, the fireplace will go into standby mode.

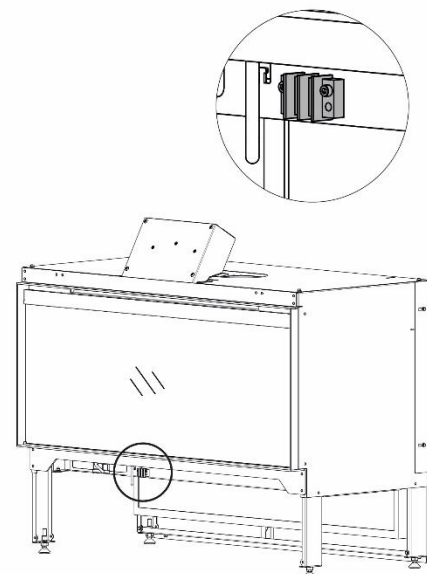

Please note that the hotel switch may be inaccessible or difficult to reach after installation.

7 Maintenance

Use a microfibre cloth to clean the glass.

Glass reflector

The glass reflector that is placed at an angle in the fireplace must be treated with care.

Instructions for cleaning the glass reflector:

- Only clean the glass with clean water: cleaning products are not recommended.
- Just dust the window or dry it with a clean microfibre cloth.
- Always dry the pane completely: water residues are difficult to remove.

Do not clean the glass reflector with any cleaning products, abrasives, cerium oxide etc. And never use hard materials such as steel wool, razor blades etc.

To clean the glass reflector, remove the front window from the fireplace. To do so, follow these steps:

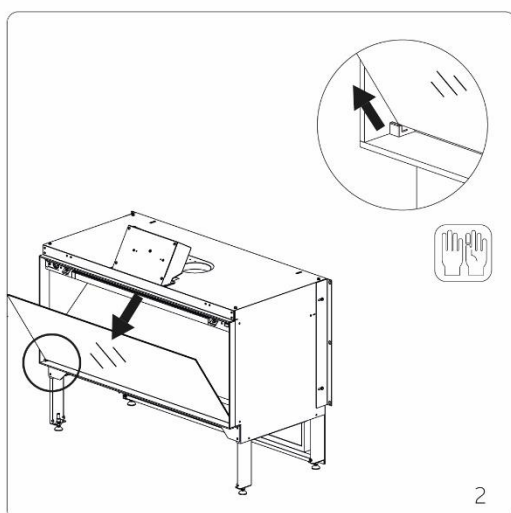
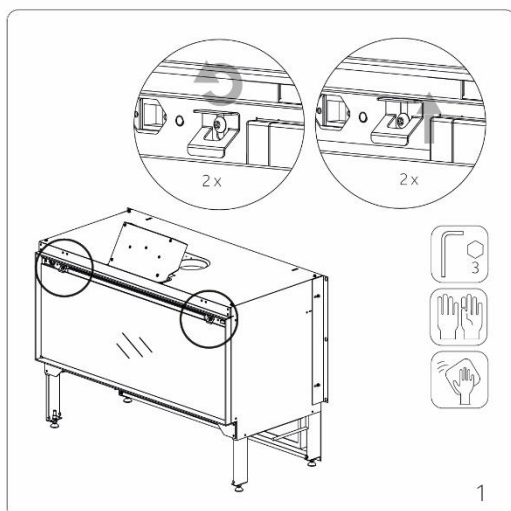

8 Troubleshooting

8.1 Incorrect position of the flames

If, after the fireplace has been started, the flames are not projected in the correct position relative to the logs, this can be solved using four supplied spacer plates. To do so, the front window, upper side walls, and glass reflector must be removed. Then remove logs A and B. Place the spacer plates over the four positioning pins for logs A and B to bring the logs into the correct position relative to the flame projection.

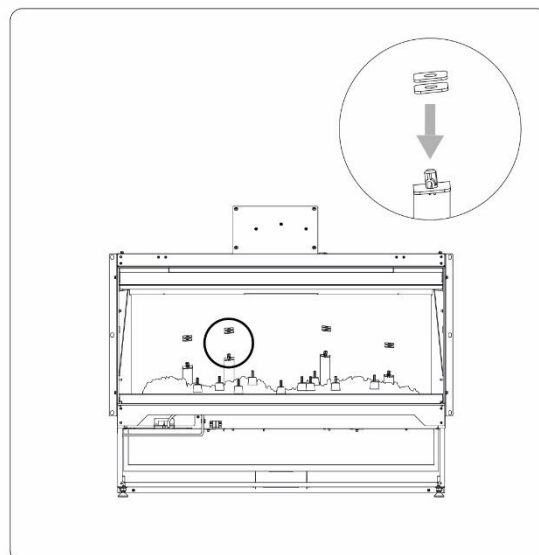

9 Technical data

KALFIRE
FIREPLACES

Model: Kalfire E-one 100F
Input: 220-240~50Hz
Power: 2100 Watt



SN:



WARNING: Do not cover heater!



WARNING: Hazardous voltage inside

Only authorized personnel may service this equipment

Energy consumption per operating mode	
standby mode (W)	1.4
standby mode, incl. anti-reflect function (W)	17
full operating mode*, excl. Atmos Heating (W)	101
full operating mode*, incl. Atmos Heating (W)	2075

*full operating mode: Dual HD Flame technology, hybrid LED E, Kalfire Sound

10 Declaration of Conformity

Kalfire B.V.
Geloërveldweg 21
NL – 5951 DH, Belfeld

Declares that the following Kalfire-brand appliance,
electric fireplace type:

Kalfire E-one 100F

is in conformity with the provisions of:

- EN/IEC 62368-1:2014/A11:2017
- IEC/EN 60335-2-30:2009
- EN 62311:2008
- EN 55032 (2015) + AC (2016)
- Article 3.2 Radio testing Harmonized EN

complies with the applicable essential requirements of
the directives.

1 June 2020

Beijko van Melick
Managing Director
Kalfire BV

11 Dimension drawing

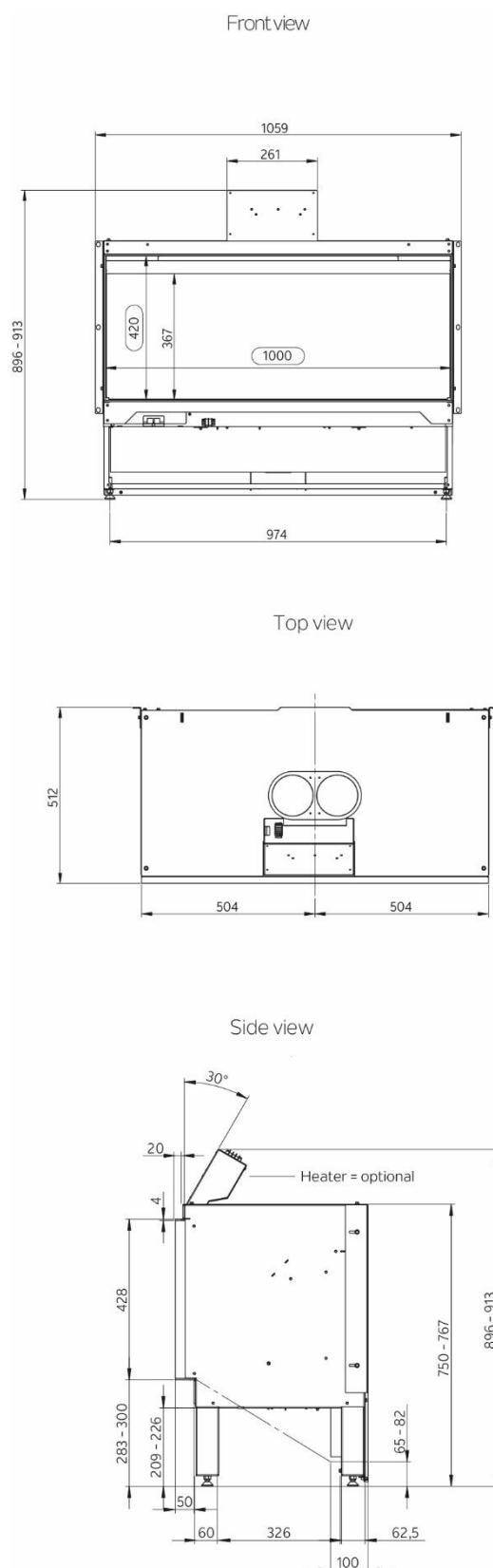



KALFIRE
FIREPLACES

Geloërveldweg 21
5951 DH Belfeld, NL
info@kalfire.com
www.kalfire.com

DON'T COMPROMISE.